

# OINGO30

## Assembly Instructions

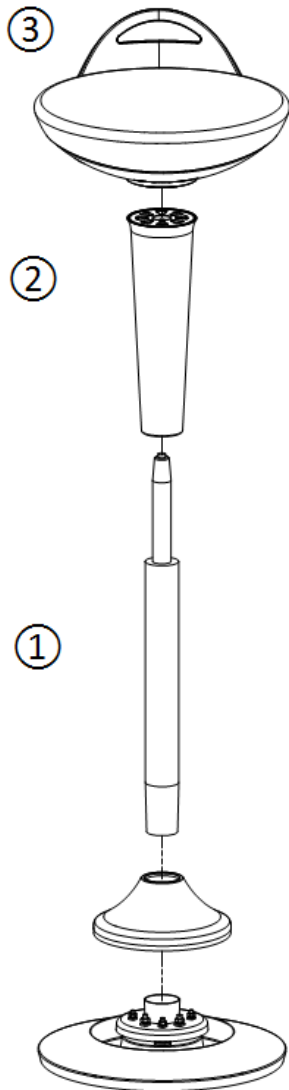

1. With the round base on floor, install base cover and insert gas lift into center of base.
2. Place telescopic cover over gas lift.
3. Position seat cushion on top telescopic column and gas lift then apply downward pressure.
4. Lift telescopic cover and attach to underside of seat cushion, so there will be no gap between telescope and seat cushion.

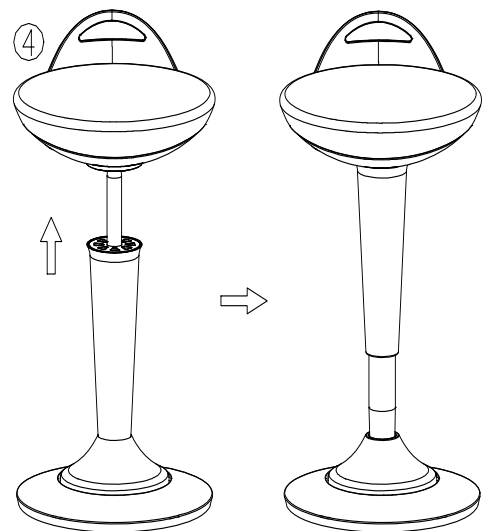

### CAUTION:

Sit on seat cushion upon assembly completion before lifting or moving product.